

HEADLIGHT DIMMER SWITCH

COMPONENTS

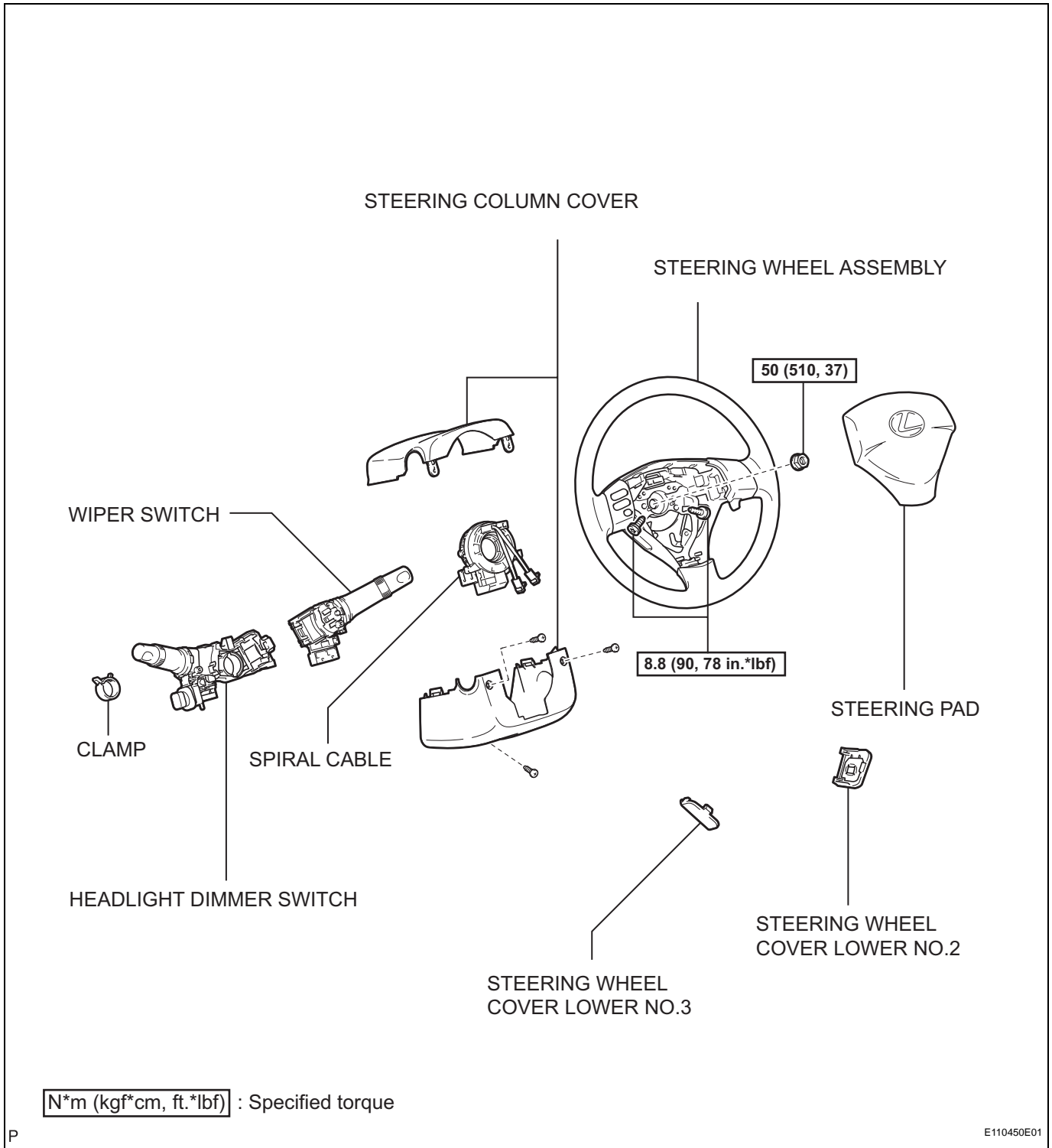

REMOVAL

1. **PRECAUTION**
(See page [RS-1](#))
2. **PLACE FRONT WHEELS FACING STRAIGHT AHEAD**
3. **DISCONNECT CABLE FROM NEGATIVE BATTERY TERMINAL**
(See page [RS-1](#))
4. **REMOVE STEERING WHEEL COVER LOWER NO.2**
(See page [RS-387](#))
5. **REMOVE STEERING WHEEL COVER LOWER NO.3**
(See page [RS-387](#))
6. **REMOVE STEERING PAD** (See page [RS-388](#))
7. **REMOVE STEERING WHEEL ASSEMBLY** (for Manual Tilt) (See page [SR-40](#))
8. **REMOVE STEERING WHEEL ASSEMBLY** (for Power Tilt and Power Telescopic) (See page [SR-50](#))
9. **REMOVE STEERING COLUMN COVER** (for Manual Tilt) (See page [SR-40](#))
10. **REMOVE STEERING COLUMN COVER** (for Power Tilt and Power Telescopic) (See page [SR-51](#))
11. **REMOVE SPIRAL CABLE** (See page [RS-399](#))
12. **REMOVE WIPER SWITCH** (See page [WW-49](#))
13. **REMOVE HEADLIGHT DIMMER SWITCH**
 - (a) Disconnect the connector.
 - (b) Disengage the claw as shown in the illustration.

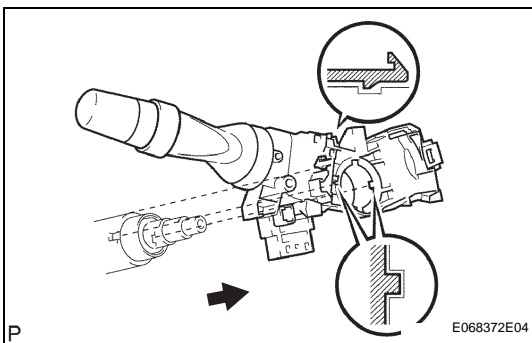
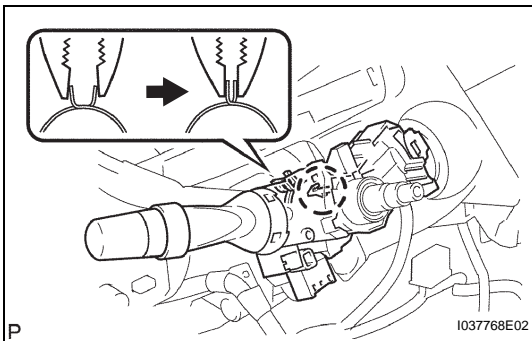

- (c) Remove the headlight dimmer switch as shown in the illustration.